

**10-12  
JUNE**

LIMA | DODOMA | LUND

# **POLLEN24**

Towards Just & Plural Futures // Hacia Futuros Plurales y Justos



## **OVERVIEW PROGRAM**

You can find the full programme [here](#)

Map of the conference venues at the end of this leaflet

**#pollen24**

**Lima -8hrs  
Lund -1hr**

**NOTE: prefix LU/DO/LI indicates hybrid sessions  
organized from Lund/Dodoma/Lima**



[Slido link](#)



[Slack link](#)

# Who is behind POLLEN24?

## Dodoma

Iddi Mwanyoka  
Wilhelm Kiwango  
Sifael Daniel  
Joan Tang'are  
Joseph Bukula  
Jacob Nyangusi  
Monica Kapinga  
Mathew Bukhi Mabele

## Lima

Ana Watson  
Deborah Delgado  
Eduardo Romero  
Diego Geng  
Diego Espejo  
Karen Maldonado  
Pilar Anaya  
Sydney Moss

## Lund

Wim Carton  
Mine Islar  
Torsten Krause  
Lina Lefstad  
Charlotta Kjöllnerström  
Inge-Merete Hougaard  
Jens Friis Lund  
Leonie Alena Saleth  
Francois Questiaux  
Stine Krøijer  
Mattias Borg Rasmussen  
Vasna Ramasar  
Rae Lorraine Dunbar

## Lund volunteers

Abhishek Reddy Kandadi, Aleksas Vinskas, Alva Cecilia von Pistohlkors, Anggia Dian Mayana, Anna Kerstin Strenkert, Archana Chikatmarla, Bucur-Iosif Mironescu-Iancu, Charly Hergert, Colin Fuchs, Dagmar Ort, Dominik Rákos, Edgar Benitez, Emily Hill, Hieu Hanh Nguyen (Julie), Huipu Li, Humairah Sabiladiyni, Jakob Brix Georgsen, Janice Swan, Jil Kristin Hollekamp, Katharina Winter, Kathrin Ehlert, Laura Bazzi, Laura Ciamei, Laura Schutzmeier, Lina Pitz, Lisa Guerra, Luuk van Dongen, Malin Wöhrstein, Mariarcangela Augello, Michelle Appelros, Nguyen Anh Phung, Ronja Karvinen, Sebastián Dávalos, Siri Arvidsson, Talia Masino

Program layout by Emmeline Werner



## Sponsors



# POLLEN24 care guidelines

The conference is organized in alignment with the core values and principles of the POLLEN network. Some of the key principles we will be following and asking you to maintain are the following:

## **Inclusive**

Ensuring equality in terms of gender, race, and LGBTQ+ representation is of utmost importance in the organization of this conference. All conference committees and organizing bodies strive to maintain spaces for open expression. The conference emphasizes the use of inclusive language in official communications and during the event itself.

POLLEN provides an inclusive platform for the 'cross-fertilization' of ideas where many rich, diverse traditions can come together, discuss, and debate the latest developments in the field. The conference should be a space that promotes respectful and caring exchanges across academic disciplines and cultures. We accept that conflict is generative but will not tolerate abuse.

## **Care**

We ask all participants to be aware of the power dynamics in the space and to participate with care; kindness and patience. We ask for people to practice deep listening; share generously; embrace curiosity and give space to others.

## **Sustainability**

We prioritize minimizing environmental and social impact throughout the preparation and execution of the conference. This includes considerations such as sustainable catering choices, venue selection, and partnering with suppliers who share our commitment to sustainability. We ask you to contribute through bringing your own water bottle (you can drink water from the tap) and coffee/tea cup and paying attention to recycling. All lunch options will be vegetarian or vegan by default.

## **Accessibility**

The event aims to be as inclusive as possible by providing step-free access for people with mobility needs. Additionally, we will accommodate a range of dietary requirements and preferences, such as lactose and gluten intolerance, as well as allergies. We also respect the different intellectual and emotional needs that people might have and are ready to offer support in different ways should this be required. Please reach out when needed.

## **Take responsibility for yourself, your well-being and your boundaries**

We are aware that everyone has different needs and we ask that you please take exquisite care of yourself and your physical, intellectual and emotional boundaries and exercise caution and discernment at all times. You're welcome to contact us by emailing [vasna.ramasar@hek.lu.se](mailto:vasna.ramasar@hek.lu.se) for emotional support or to share a concern or any harmful behavior you encounter. We will also have people on-site throughout the event who are ready and available to listen and help you navigate your experience.

# 10 JUNE



## Welcome and coffee

**09.00-10.00**

Coffee and registration

### Room

Matte Annexet

## Parallel Session 1

**10.00-11.30**

No.	Title	Room
LU192	Political Arenas of Infrastructuring African Futures	Kårhuset Aula
323	Political afterlives of ecological change I	Matte 1
177	Socio-ecological vulnerabilities, resistance, and the potential for more equitable and sustainable societies	Matte 2
265	Political Ecologies of carbon removal, net zero and climate delay I	Matte 3
346	The political ecology of nature-based value chains	Matte 4
303	Teaching Political Ecology and Environmental Justice with and against the canon	Matte 5
79	Geopolitical Ecology of Extractivist Empire-Making I	Matte 6
604	Resisting Infrastructure	Matte 7
601	Political ecologies of the oceans and marine environments I	E1123
116	Meaty Futures: Political ecologies of meat and meat alternatives I	E1124
199	Political ecologies of landscapes of restoration and restoration of landscapes	E1144
608	Political Ecology of Climate Adaptation	E1145
615	Insurgent ecologies and earthly movements - authors' roundtable	E1147
622	Green energy conflicts	E1426
603	Claiming wetlands	E1406

## Lunch break

**11.30-13.00 / Matte Annexet**

## Parallel session 2

13.00-14.30

No.	Title	Room
D067	Experiences etc. of community engagement in protected areas in India I	Kårhuset Aula
323	Political afterlives of ecological change II	Matte 1
185	Political ecologies of change: Degrowth as transformation I	Matte 2
265	Political Ecologies of carbon removal, net zero and climate delay II	Matte 3
363	Building a Political Ecology of Education: Critical Dialogues on the Politics of Knowledge	Matte 4
242	Participatory Visual Methods for Political Ecology I – Paintings	Matte 5
79	Geopolitical Ecology of Extractivist Empire-Making II	Matte 6
159	Political Ecology, Geopolitics and the International I	Matte 7
249	Roundtable: Weaving Alternatives to Polycrises: The Global Tapestry of Alternatives	E1123
116	Meaty Futures: Political ecologies of meat and meat alternatives II	E1124
12	Hesitant energy transitions and exclusionary futures in Latin America – authors' roundtable	E1144
607	Crises, care & repair I	E1145
111	The Politics of Invisibility in Conservation I	E1147
623	Local perspectives on energy transitions	E1426
601	Political ecologies of the oceans and marine environments II	E1406

## Coffee break

14.30-15.00 / Matte Annexet

## Parallel session 3

15.00-16.30

No.	Title	Room
947	Political ecology of genocide	Kårhuset Aula
96	Volatile rivers and the political ecology of infrastructure	Matte 1
185	Political ecologies of change: Degrowth as transformation II	Matte 2
265	Political Ecologies of carbon removal, net zero and climate delay III	Matte 3
609	Food sovereignty	Matte 4
242	Participatory Visual Methods for Political Ecology II Photovoice and Participatory Photography	Matte 5
627	Searching for sustainability in research and praxis I	Matte 6
159	Political Ecology, Geopolitics and the International II	Matte 7
633	Locating Social Identities in Political Ecologies of Urbanism	E1123
605	Beyond precarious and colonial conservation – authors' roundtable	E1124
155	Integrating ecology in political ecology research on agriculture	E1144
607	Crises, care & repair II	E1145
363	Building a Political Ecology of Education: Critical Dialogues on the Politics of Knowledge	E1147
327	How can political ecology inform Global Sustainability Goals for the Global North post-Agenda 2030/ the United Nations SDGs?	E1426
628	Metabolisms and Planning in the Urban	E1406

## Break

**16.30-16.45**

---

*Please walk to the plenary session if you are not in the same building*

## Opening plenary session: Toward Plural and Just Futures

**16.45-18.15 / Kårhuset Aula**

---

The official opening of the POLLEN24 conference will be held as a joint hybrid plenary with hosts at each of the venues joining a call broadcasting from all three venues simultaneously. Participants at all three conference sites will be in plenary, for Q&A during the hybrid session.

During the opening plenary, we will invite one scholar at each of the sites to give a short reflection on their experience of political ecology research in their context and what are the exciting directions they see the field heading in.

To close the opening plenary, we have a final message from the local organisers (also including logistics).

The session will be moderated by Mathew Bukhi Mabele, Mine Islar and Maritza Paredes

### Speakers:

Anwasha Dutta (Chr Michelsen Institute), Adeniyi Asiyanni (University of British Columbia) and Grettel Navas (Universitat Oberta de Catalunya & University of Chile)

More details on the speakers [here](#)

## Opening reception

**18.30-20.30 / Matte Annexet**

---

# 11 JUNE



## Parallel session 4

08.00-09.30

No.	Title	Room
301	Towards a Political Ecology of Roma Environmental Vulnerability in Europe	Kårhuset Aula
617	Himalayan political ecologies	Matte 1
375	Possibilities and Problematics at the Intersection of Community Economies and Convivial Conservation I	Matte 2
265	Political Ecologies of carbon removal, net zero and climate delay IV	Matte 3
32	The Pluriverse of transitions I	Matte 4
352	Urban Natures. Living the more-than-human city - authors' roundtable	Matte 5
627	Searching for sustainability in research and praxis II	Matte 6
310	Governing, producing, and negotiating reindeer landscapes – towards fair and sustainable use of land	Matte 7
293	Just Transitions and Rural Environmental Justice in Europe I	E1123
640	[CANCELLED] Dialogue: Unfolding potentials of peace and conflict work amid the social-ecological transformation	E1124
343	A World Ecology of Development, Disasters and 'Economic/ Environmental Offshoring' in the Making of East Asian Regionalism	E1144
613	The political ecology of islands in the Anthropocene I	E1145
641	Examining the many meanings of geopolitics	E1147
610	Struggles over Land and Livelihoods in West and East Africa	E1426
634	Power, subjectivity and agency	E1406

## Coffee break

09.30-10.00 / Matte Annexet

## Parallel session 5

10.00-11.30

No.	Title	Room
D027	Political ecology of connectivity and conservation I	Kårhuset Aula
232	Political Ecology of Glacierized Environments	Matte 1
263	Roundtable: A movement of many movements. How we build convergence between struggles in a world on fire	Matte 2
265	Political Ecologies of carbon removal, net zero and climate delay V	Matte 3
32	The Pluriverse of transitions II	Matte 4
618	Engaging with 'waste'	Matte 5
119	Territory, Ecology, and Violence in Latin America I	Matte 6
LU135	Contested imaginaries? Eclectic pathways of agrarian change I	Matte 7
600	Political Ecologies of Conservation in Namibia	E1123
293	Just Transitions and Rural Environmental Justice in Europe II	E1124
375	Possibilities and Problematics at the Intersection of Community Economies and Convivial Conservation II	E1144
613	The political ecology of islands in the Anthropocene II	E1145
614	Resisting extractivism, envisioning just and sustainable futures	E1147
625	More-than-human political ecologies	E1426
636	Roundtable: Aiming for justice in global agricultural supply chains	E1406

## Lunch break

11.30-13.00 / Matte Annexet

## Parallel session 6

13.00-14.30

No.	Title	Room
D027	Political ecology of connectivity and conservation II	Kårhuset Aula
616	Decolonizing ecologies	Matte 1
378	Bridging Perspectives: Locating the Synergies Across Political Ecology and Agroecology for Transformative Food System Futures	Matte 2
265	Political Ecologies of carbon removal, net zero and climate delay VI	Matte 3
32	The Pluriverse of transitions III	Matte 4
242	Participatory Visual Methods for Political Ecology III – Comics and documentary	Matte 5
119	Territory, Ecology, and Violence in Latin America II	Matte 6
LU135	Contested imaginaries? Eclectic pathways of agrarian change II	Matte 7
65	Open space: What might it mean to take ecology seriously?	E1123
375	Possibilities and Problematics at the Intersection of Community Economies and Convivial Conservation III	E1124
347	Political Epistemologies and Ontologies I	E1144
611	Resistance and transformation I	E1145
139	Animal Political Ecologies: Blindspots and novel approaches I	E1147
626	Thinking and enacting plural futures	E1426
637	Audio-visual performance: Bark as Armour	E1406



## Coffee break

14.30-15.00 / Matte Annexet

---

## Parallel session 7

15.00-16.30

No.	Title	Room
LU315	Diverse Ways of Knowing the Climate: Towards Epistemic Climate Justice I	Kårhuset Aula
D042	The lives, afterlives, and resurgence of nature-based solutions	Matte 1
360	Ecologies of Crisis: Anthropological Perspectives on the Governance of Environmental Resources under Compounding Crises	Matte 2
316	Political ecologies of the post-extractive landscape	Matte 3
LI64	Decolonising the normative foundations of political ecology I	Matte 4
242	Participatory Visual Methods for Political Ecology III – Screening of documentaries	Matte 5
119	Territory, Ecology, and Violence in Latin America III	Matte 6
LU305	Infrastructure Sabotage as Future-Making I: De-/Constructive Infrastructure Sabotage	Matte 7
LI23	Questioning the ecological and justice outcomes of NbS I	E1123
211	More-than-Human Mappings: Cultural and Domestic/Everyday Perspectives I	E1124
347	Political Epistemologies and Ontologies II	E1144
611	Resistance and transformation II	E1145
139	Animal Political Ecologies: Blindspots and novel approaches II	E1147
642	Making Methods and Sense Together – an installation	E1426

## Break

16.30-16.45 / Matte Annexet

---

*Please walk to the plenary session if you are not in the same building*

## Plenary session: Dialogues, Encounters

16.45-18.15 / Kårhuset Aula

---

As political ecologists, we recognize that all research is political. The field of political ecology has developed in conversation with the world – through learning from social movements and activists. Contributions include (1) highlighting the political nature of socio-ecological relations; (2) through transdisciplinary and participatory action research to have real-world and real-time impact; and (3) through an evolving understanding of how different knowledges and lived experiences need to shape political ecology theorising. This plenary seeks to acknowledge and honor the voices of communities living political ecology through their everyday defense and creation of life. We invite three indigenous speakers to reflect with us on why political ecology can and should matter to creating the world we want to live in.

The session will be moderated by Vasna Ramasar, Deborah Delgado and Iddi Mwanyoka.

### Speakers:

Michael Bro is Inuit, born and raised in Ilulissat Nunarput. Michael Bro is an activist, champion of indigenous rights and active in the debate on the decolonization of Kalaallit Nunaat (Greenland)

Marisol García Apagueño is a Kichwa leader from the Tupac Amaru Indigenous community and currently serves as President of the Federation of Kichwa Indigenous Peoples of Chazuta Amazonas (FEPIKECHA)

Endeko S. Endeko from the Hadzabe (hunters and gathers) community. Endeko is a community representative under the auspices of the Ujamaa Community Resource Team (UCRT)

More information about the speakers can be found [here](#)

# 12 JUNE



## Morning coffee

09.30-10.00 / Matte Annexet

Room

Coffee and registration

Matte Annexet

## Parallel Session 8

10.00-11.30

No.	Title	Room
D035	Putting critique into practice: Political Ecologists as Change Agents in Global/Local Wildlife Conservation	Kårhuset Aula
362	Ecologies of speculation - Imagining environmental and spatial justice beyond interconnected crises	Matte 1
203	How can Biosphere Reserves be Places of Environmental Justice? I	Matte 2
265	Political Ecologies of carbon removal, net zero and climate delay VII	Matte 3
107	Political ecologies of 'green' authoritarianism I	Matte 4
299	Biodiversity conservation and the value turn I	Matte 5
271	Smart and climate just housing I	Matte 6
LU255	Green transition as decolonization? I: Disrupting legacies of colonial power?	Matte 7
223	Interrogating ontologies and epistemologies through co-creation of diverse knowledges: (Decolonial) Political ecology meets political ontology in the Global South and North	E1123
181	Roundtable: What is the role of academics in the current wave of capitalist driven green extractivism?	E1124
633	Locating Social Identities in Political Ecologies of Urbanism	E1144
612	Livelihoods and adaptation in Bhutan I	E1145
619	Political ecologies of water	E1147
629	Framing and discourse in political ecology	E1426
638	Workshop: Care (against) the Anthropocene. How to make kin in the ruins of Climate Change	E1406

## Lunch break

11.30-13.00 / Matte Annexet

## Parallel session 9

13.00-14.30

No.	Title	Room
602	Amazonian struggles over resources	Matte 1
203	How can Biosphere Reserves be Places of Environmental Justice? II	Matte 2
28	Roundtable: Global resource governance and agrarian labour (re)production	Matte 3
624	Climate Change, Human Rights, and Colonialism	Matte 4
299	Biodiversity conservation and the value turn II	Matte 5
271	Smart and climate just housing II	Matte 6
340	Exploring transitions for marine environmental governance	E1123
17	Urban Frontiers. From Illegal Land Occupation to Legalized Property	E1124
339	Social-ecological crisis and rural resistances in mountain peripheral areas: emergent emancipatory political subjects in the Catalan Pyrenees (NE Spain)	E1144
612	Livelihoods and adaptation in Bhutan II	E1145
620	Political ecologies of agriculture	E1147
630	Political Ecologies of Land and Conservation	E1426

## Coffee break

14.30-15.00 / Matte Annexet

## Parallel session 10

15.00-16.30

No.	Title	Room
LU315	Diverse Ways of Knowing the Climate: Towards Epistemic Climate Justice II	Kårhuset Aula
LU255	Green transition as decolonization? II: Decolonizing conservation and management practices	Matte 1
319	Exploring alternative futures by reflecting on the value frameworks that have shaped 15 years of PES history	Matte 2
107	Political ecologies of 'green' authoritarianism I	Matte 3
LI64	Decolonising the normative foundations of political ecology II	Matte 4
606	Carbon offsetting and biodiversity	Matte 5
377	Manufactured super creatures for damaged environments	Matte 6
LU305	Infrastructure Sabotage as Future-Making II: In-/Visible Infrastructure Sabotage	Matte 7
LI23	Questioning the ecological and justice outcomes of NbS II	E1123
211	More-than-Human Mappings: Cultural and Domestic/Everyday Perspectives II	E1124
632	The politics of disaster and risk	E1144
276	Roundtable: Racing to climate justice: exploring the temporalities of just sustainability transformations	E1145
621	Agrarian transformations	E1147
631	Geopolitics, conflict and justice in conservation	E1426
639	Unravelling the Political Ecology of Technologies and Digitalisation in the Agri-food System	E1406

## Break

16.30-16.45 / Matte Annexet

---

Please walk to the plenary session if you are not in the same building

## Closing plenary session: Just and plural political ecologies: Traditions and Futures

16.45-18.15 / Kårhuset Aula

---

Over the last 30 years, the field of Political Ecology has grown rapidly as a result of emerging socio-ecological challenges, actions by social movements, conceptual and methodological innovation, and the diversification of voices, especially from the Global South. Three journals in political ecology – The Journal of Political Ecology/Grassroots, Ecología Política, and the Journal of the Geographical Association of Tanzania (JGAT) – invite contributions to an open conversation about "Just and Plural Political Ecologies: Traditions and Futures."

At the POLLEN 2024 conference, the three abovementioned journals will participate in a plenary session on "publishing for just and plural political ecologies," commenting on major themes from the conference and the role of our journals in disseminating knowledge. Journal editors will form a plenary panel on the last day where they will discuss issues identified across the three locations at the meeting:

- 1) dominant and emergent tendencies in the field, and the promise of just and plural futures emerging from the knowledge practices of political ecology.
- 2) the role of publishing to nurture plural and just socio-ecological futures, and the challenges to advancing a pluralization of knowledge and practice within political ecology.
- 3) the kinds of submissions the journals would like to receive that would promote ecosocial justice and advance the pluralization of practices and knowledges.

For more information, click [here](#) to see the full Call for Papers

## Closure of Lund conference

18.15-18.30

---

### Room

Moles reporting back

Kårhuset Aula

## Closing party and ending party

19.00-01.00

---

### Venue

Pre-registration and ticket is required

Kulturmejeriet,  
Stora Södergatan 64,  
222 23 Lund

# Moving around POLLEN2024

Main location is **Matte Annexet**, at Sölvegatan 20 in Lund. **This is where registration happens on Monday morning – please enter where the red arrow is pointing.** On this address you find all rooms called “Matte”. Coffee/tea and lunch will be served here.

The second location is **E-Huset**, at Ole Römers väg 3. These rooms are used for parallel sessions, and all rooms are located on the ground floor. It is approx. 250 meters walking from Matte to E-Huset. On this address you find all rooms starting with “E”, e.g. “E1123”.

Plenaries take place at **Kårhuset**, on John Ericssons väg 3, in the Aula (enter the building and go up the stairs). Kårhuset is just across the street from Matte Annexet and E-Huset, approx. 200m from each. Please note the Aula has a maximum capacity of 400 people. When the Aula is filled to capacity, we will re-direct participants to Matte where the plenaries will be livestreamed (Questions will be taken on Slido, so you can participate/listen in equal measure whether listening in from the Aula or from Matte).

## MAPS

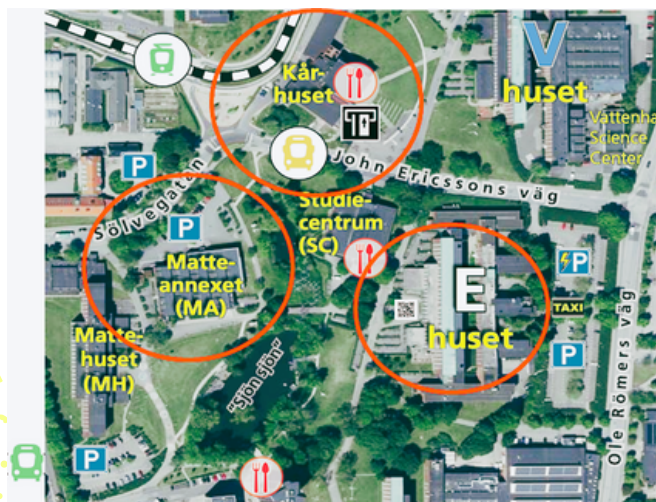

Overview of the three conference buildings and surrounding public transport. The tram goes from Lund C and stops at “LTH”. City buses (green) and regional buses (yellow) stop nearby. By public transport from Lund C it takes approx. 5 minutes to reach the conference site, or approx. 20 minutes by walking. A larger map of the area can be found [here](#).

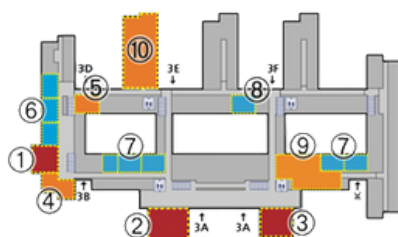

### Våning 1:

- Hörsalar: ① 1406, ② E:A, ③ E:B
- ④ Bibliotek
- ⑤ Sammanträdesrum 1426
- Seminarierum: ⑥ 14xx, ⑦ 11xx, ⑧ 1328
- ⑨ Café
- ⑩ L-Tek

Overview of E-Huset. Please note we have rooms E14xx (the three rooms indicated as 6 on the map) and E11xx (the five rooms indicated as 7 on the map). When walking from Matte Annexet or Kårhuset you will arrive at entrances 3A/3B.